

# METAL ROOFING SYSTEMS

## SMI 1.5" FF SnapLock Standing Seam

### Panel Information:

Panel Type:	Standing Seam
Panel Seam:	SnapLock
Panel Width:	14.75"
Seam Height:	1.5"
Panel Material:	22 GA - 24 GA Min
Panel Surface:	Smooth / Embossed Optional
Panel Clip:	None
Minimum Slope:	3/12
Substrate:	Plywood

### Panel Testing:

Hail Rating:	Class 4 Impact UL 2218
Fire Rating:	UL Class A

### Panel Notes:

- This panel uses a 20" coil.
- This panel uses 5-5/16" of material to form the panel.
- Divide the coil width by the panel width to determine your roof multiplier. Take the square footage of the roof and multiply that by the roof multiplier to determine the amount of coil needed to manufacture the panels. This does not include estimated waste.
- This panel is NOT approved for Weathertight Warranties.

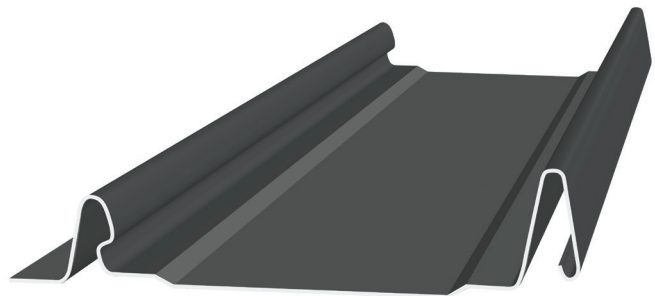
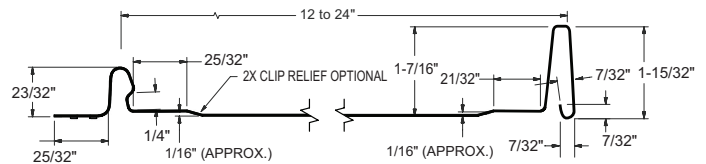
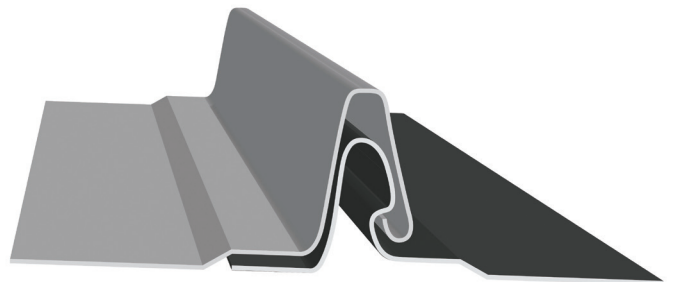

**Sheffield Metals  
International**  
A MAZZELLA COMPANY

CLEVELAND: 800.283.5262  
ATLANTA: 800.929.9359  
DALLAS: 877.853.4904  
DENVER: 877.375.1477  
LA MIRADA: 562.383.9800  
[sheffieldmetals.com](http://sheffieldmetals.com)